

OPTO INTERFACE MODULE

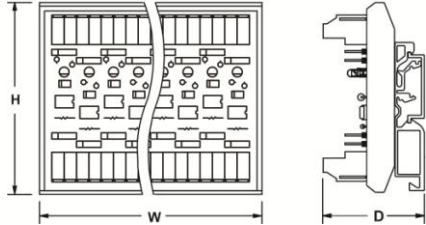

Dimensions

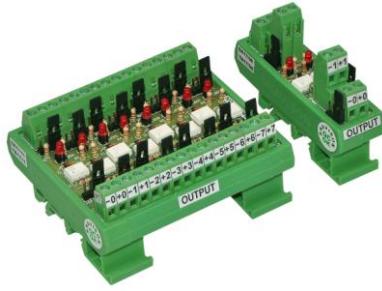
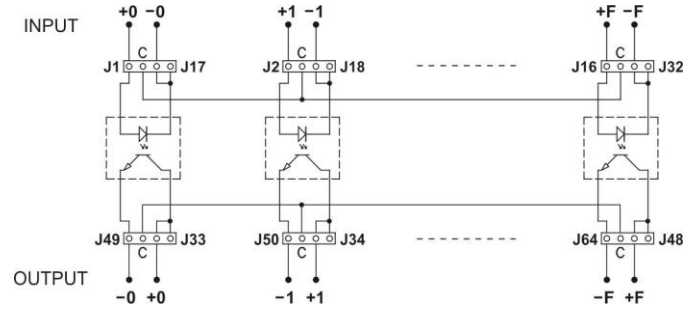

Schematic

Note : Default jumper setting is isolated for both input & output.
INPUT Looping : +Ve Common – Place jumpers J1 to J16
 -Ve Common – Place jumpers J17 to J32
OUTPUT Looping : +Ve Common – Place jumpers J33 to J48
 -Ve Common – Place jumpers J49 to J64

Typical Connections :

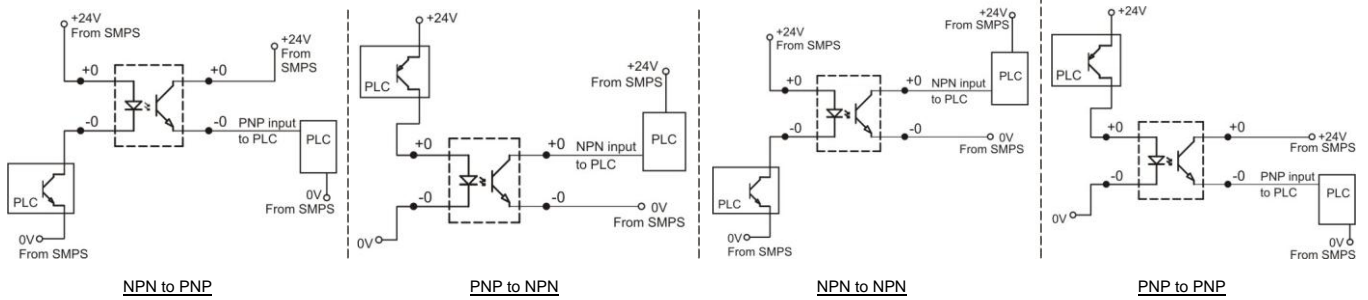

FEATURES	<ul style="list-style-type: none"> Optical Isolation between Input & Output Low Input Current Negligible switching delay 	<ul style="list-style-type: none"> +Ve or -Ve common through jumper selection Can be used as NPN to PNP Converter or vice versa
-----------------	---	---

NO. OF CHANNELS	2, 4, 6, 8, 16
------------------------	----------------

INPUT	INPUT VOLTAGE	1.3 ~ 1.8VDC	3.2 ~ 3.6VDC	5VDC +/-10%	12VDC +/-10%	15VDC +/-10%	24VDC +/-10%
	INPUT CURRENT PER CHANNEL ⁽¹⁾	< 15mA					
	MAX. OPERATING FREQUENCY	10KHz					
OUTPUT	RATING	5V – 30VDC, 15mA					
	OFF STATE LEAKAGE CURRENT	< 20µA / -300mV @30V DC					
	OUTPUT VOLTAGE	5V	12V	15V	24V	30V	

DIELECTRIC STRENGTH	1. Inputs - channel to channel (when isolated) : 100VAC, 50/60 Hz for 1 minute 2. Input to Output : Optical - 500VAC, 50/60 Hz for 1 minute 3. Outputs - channel to channel (when isolated) : 100VAC, 50/60 Hz for 1 minute
----------------------------	---

OPERATING AMBIENT	0-55°C, 85% RH
--------------------------	----------------

STORAGE AMBIENT	-20°C to 85°C
------------------------	---------------

TERMINATIONS	INPUT SIDE	Screw type, for 2.5mm sq. wire
	OUTPUT SIDE	Screw type, for 2.5mm sq. wire

MOUNTING	35 mm DIN rail
-----------------	----------------

ORDERING INFORMATION	AS525, - 5V					
	NO. OF CHANNELS	DESIGN NO.	INPUT VOLTAGE	OUTPUT VOLTAGE	DIMENSIONS W x H x D (mm)	WEIGHT (MAX)
	2	AS522	3.3V : 3.3VDC 5V : 5VDC 12V : 12VDC 15V : 15VDC 24V : 24VDC	5V – 30VDC (15mA)	24 x 80 x 70	50 grams
	4	AS523			46 x 80 x 70	90 grams
	6	AS524			68 x 80 x 70	130 grams
	8	AS525			91 x 80 x 70	150 grams
16	AS527	152 : 1.3-1.8VDC		182 x 80 x 70	280 grams	

Note : 1. Current including LED current.